



DC Blower fan

AG5010S 50*50*10mm

- Motor:DC
- Bearing:Ball、sleeve、Hydraulic
- Shell frame: PBT UL94V-0
- Fan blade: PBT UL94V-0
- Insulation:Class B
- Wire:AWG#26UL1007 (optional)
- PIN1:BLACK WIRE----(-)
- PIN2:RED WIRE----(+)



DIMENSIONS DRAWING(unit:mm)

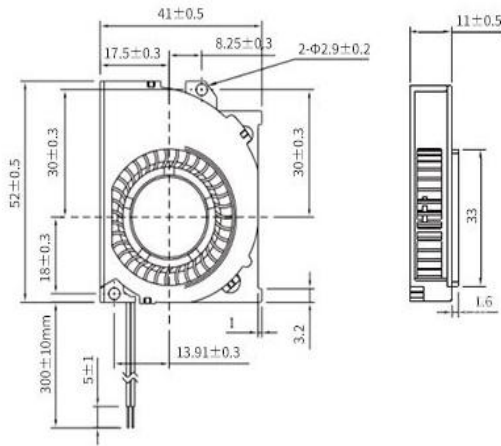

P@Q CURVE(AT RATED VOLTAGE)

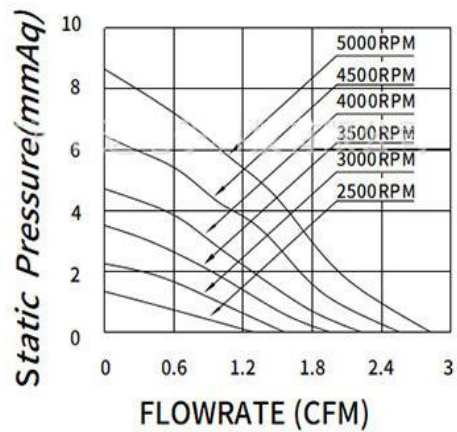

Model	Bearing Mode①	Rated	Operating	Rated	Rated	Speed	Maximum		Maximum		Noise
		Volt	voltage range	current	input power		air Flow	Air pressure	mmH2O	InH2O	
PART. NO.		VDC	VDC	Amp	Watt	R. P. M	M3/min	CFM	mmH2O	InH2O	dB-A
AG5010S05L	B=Ball S=Sleeve H=Hydraulic	5	3.6~6.8	0.05	0.25	2500	0.037	1.34	1.31	0.051	18.4
AG5010S05M		5	3.6~6.8	0.06	0.35	3000	0.063	2.25	1.56	0.061	21.0
AG5010S05H		5	3.6~6.8	0.12	0.60	3500	0.098	3.49	1.95	0.076	22.6
AG5010S05HH		5	3.6~6.8	0.16	0.80	4000	0.133	4.73	2.23	0.087	25.1
AG5010S05VH		5	3.6~6.8	0.26	1.30	4500	0.182	6.45	2.56	0.1	28.1
AG5010S05HV		5	3.6~6.8	0.37	1.85	5000	0.244	8.64	2.83	0.111	32.1

AG5010S12L	B=Ball S=Sleeve H=Hydraulic	12	7.5~13.5	0.02	0.24	2500	0.037	1.34	1.31	0.051	18.4
AG5010S12M		12	7.5~13.5	0.03	0.39	3000	0.063	2.25	1.56	0.061	21.0
AG5010S12H		12	7.5~13.5	0.05	0.60	3500	0.098	3.49	1.95	0.076	22.6
AG5010S12HH		12	7.5~13.5	0.07	0.86	4000	0.133	4.73	2.23	0.087	25.1
AG5010S12VH		12	7.5~13.5	0.11	1.32	4500	0.182	6.45	2.56	0.1	28.1
AG5010S12HV		12	7.5~13.5	0.16	1.92	5000	0.244	8.64	2.83	0.111	32.1

①Bearing Mode:Ball/ Sleeve/Hydraulic/Ball (UL)/Sleeve (UL)Hydraulic (UL)

②X=Function: FG RD RDL LD PWM TP VC RC CS RP SS AS CL IPX5

③A=Plug

④C=Customized by customers: Air volume, Air duct, Movement, Service life, Temperature, Noise, Material, Mold.etc.

导引: 编码规则Code Rule

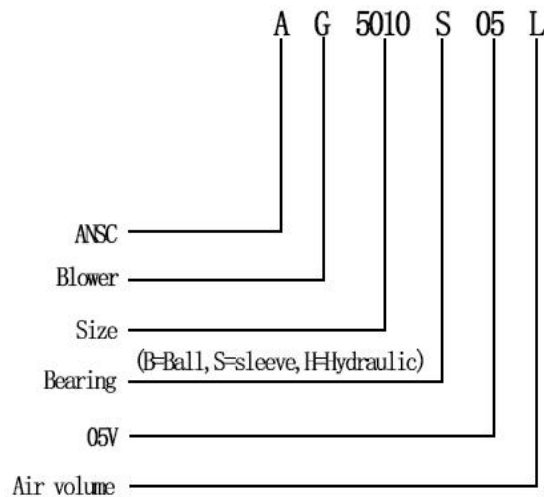

*PROPRIETARY AND CONFIDENTIAL , THE INFORMATION CONTAINED IN THIS DRAWING IS THE SOLE PROPERTY OF <ALL NEW SEMI>.
ANY REPRODUCTION IN PART OR AS A WHOLE WITHOUT THE WRITTEN PERMISSION OF <ALL NEW SEMI> IS PROHIBITED.

<https://allnewsemi.com>
<https://allnewsemi.shop>