



DC Blower fan

AG2006S 20*20*6mm

Motor:DC

Bearing:sleeve、Hydraulic

Shell frame: PBT UL94V-0

Fan blade: PBT UL94V-0

Insulation:Class B

Wire:AWG#26UL1007 (optional)

PIN1:BLACK WIRE----(-)

PIN2:RED WIRE----(+)



DIMENSIONS DRAWING(unit:mm)

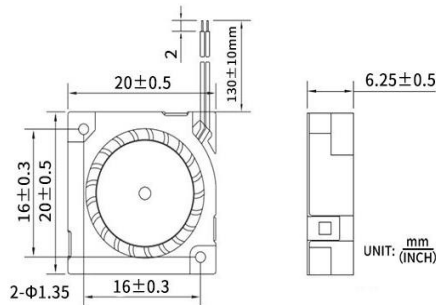

P@Q CURVE(AT RATEDVOLTAGE)

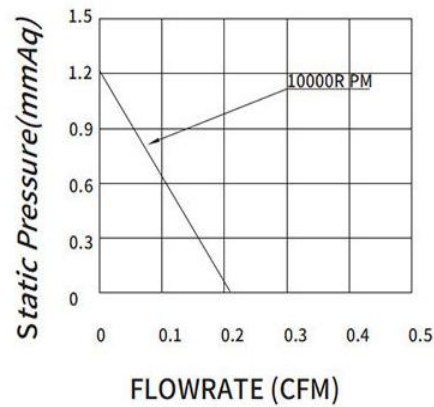

Model	Bearing Mode①	Rated Voltage	Operating voltage	Rated current	Rated input power	Speed	Maximum air Flow		Maximum Air pressure		Noise
							M3/min	CFM	mmH2O	InH2O	
PART. NO.		VDC	VDC	Amp	Watt	R. P. M					
AG2006S05M	B=Ball S=Sleeve H=Hydraulic	5	3~6	0.04	0.20	10000	0.006	0.21	1.21	0.048	<18
AG2006S12M		12	7.5~13.5	0.017	0.20	10000	0.006	0.21	1.21	0.048	<18

①Bearing Mode:Ball/ Sleeve/Hydraulic/Ball (UL)/Sleeve (UL)Hydraulic (UL)

②X=Function: FG RD RDL LD PWM TP VC RC CS RP SS AS CL
IPX5

③A=Plug

④C=Customized by customers: Air volume, Air duct, Movement, Service life, Temperature, Noise, Material, Mold.etc.

导引：编码规则Code Rule

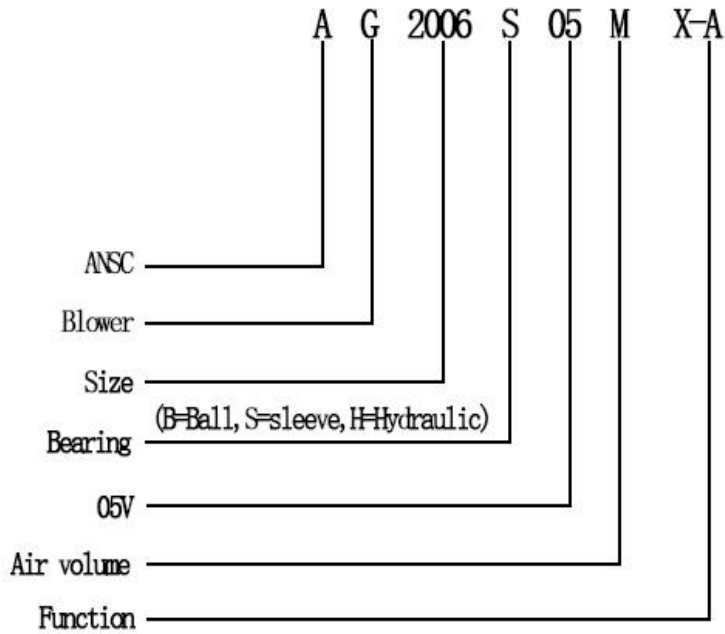

*PROPRIETARY AND CONFIDENTIAL , THE INFORMATION CONTAINED IN THIS DRAWING IS THE SOLE PROPERTY OF <ALL NEW SEMI>.
ANY REPRODUCTION IN PART OR AS A WHOLE WITHOUT THE WRITTEN PERMISSION OF <ALL NEW SEMI> IS PROHIBITED.

<https://allnewsemi.com>
<https://allnewsemi.shop>